

4

3

2

DWG. NO. 150-ST-FE SHEET 1 REV B

1

REVISIONS			
REV	DESCRIPTION	DATE	APPROVED
A	FINAL RELEASE ECO:1069-BCP	2-17-11	
B	ADD HANDLE, EXTEND FREQ TO 3GHz ECO: 15496/DMD	9-26-14	D. Downing

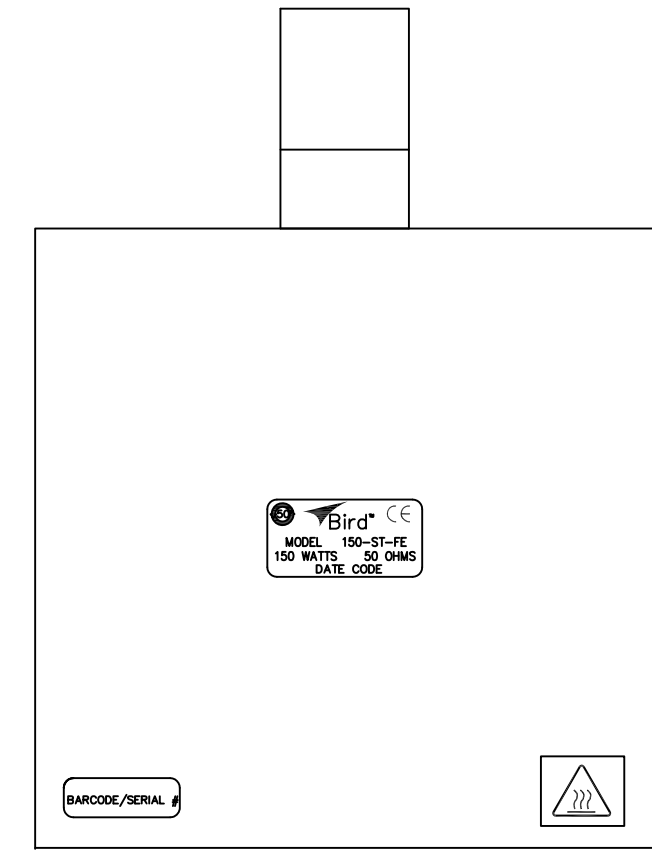
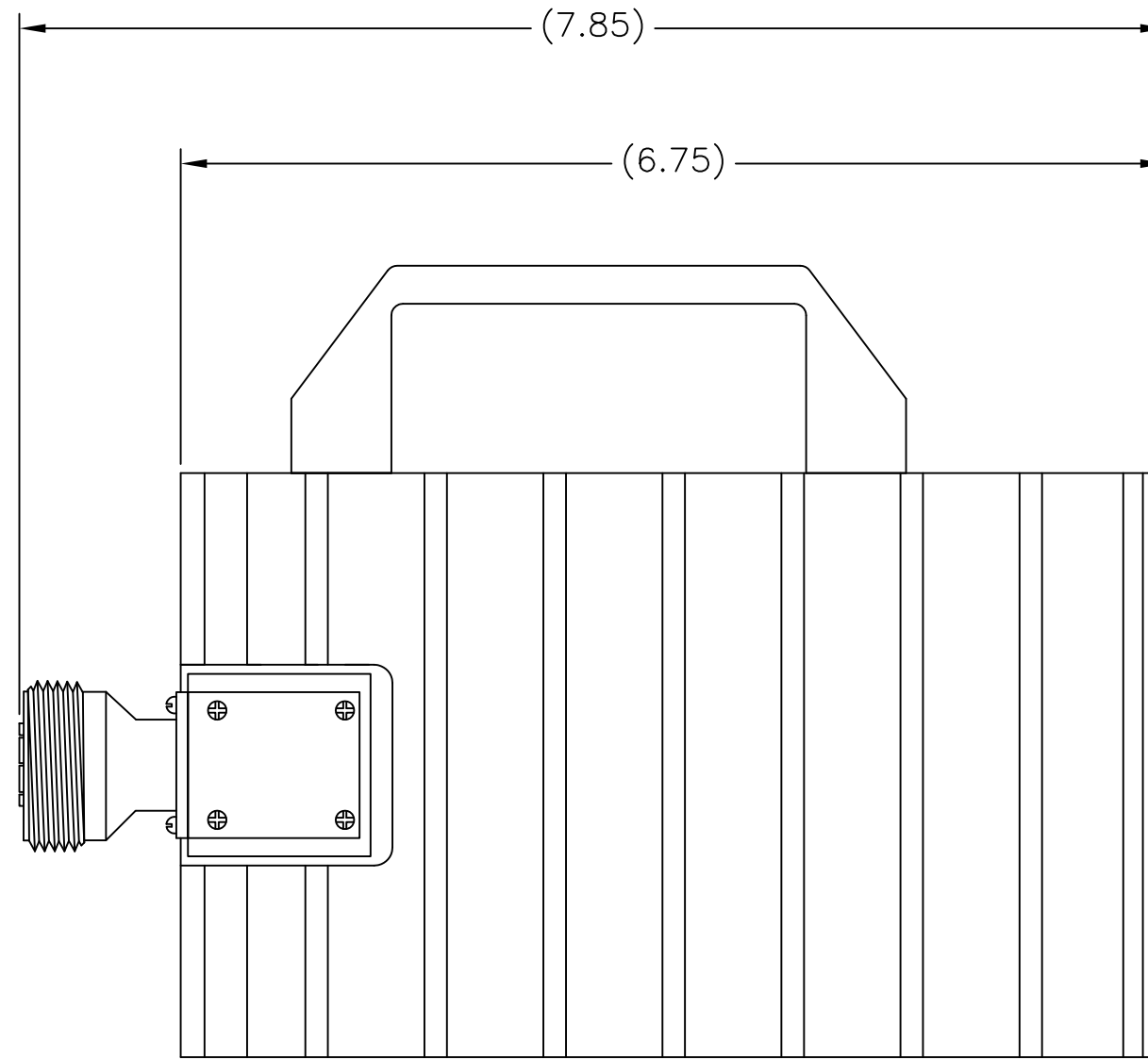
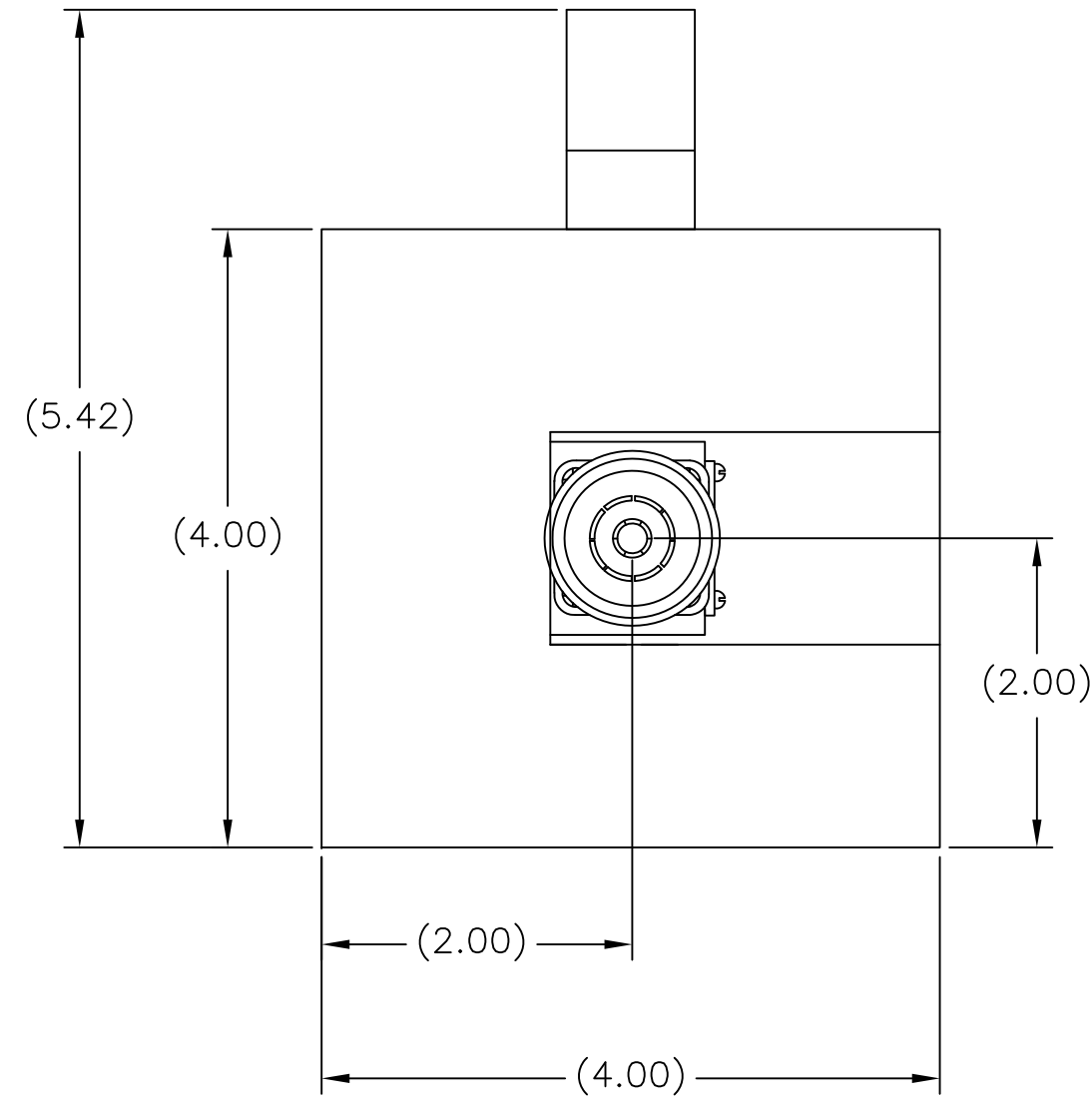

SPECIFICATIONS:
 IMPEDANCE: 50 OHMS NOMINAL
 POWER RATING: 150 CW AT 40°C
 180 CW AT 25°C
 FREQUENCY RANGE & VSWR:
 DC TO 1 GHz AT 1.10:1 MAX.
 1 GHz TO 3 GHz AT 1.25:1 MAX.
 CONNECTOR: 7/16 DIN FEMALE
 OPERATING POSITION: ANY
 AMBIENT TEMPERATURE: -45°C TO +40°C
 OPERATING TEMPERATURE: -45°C TO +120°C
 HUMIDITY: 95% NON-CONDENSED
 NOMINAL SIZE: APPROX 7.85" L X 4.00" W X 5.42" H
 WEIGHT: APPROX. 5.0 LBS

MATERIALS: ALL RoHS COMPLIANT
 CONNECTOR BODY: BRASS
 HOUSING/COVER: ALUMINUM
 COOLING FIN: ALUMINUM
 CONTACT: BRASS OR BERYLLIUM COPPER
 INSULATOR: TEFLON (PTFE)
FINISH: ALL RoHS COMPLIANT
 BODY/HOUSING/COVER: TRI-METAL
 COOLING FIN: BLACK ANODIZE
 CONTACT: SILVER OR GOLD PLATED

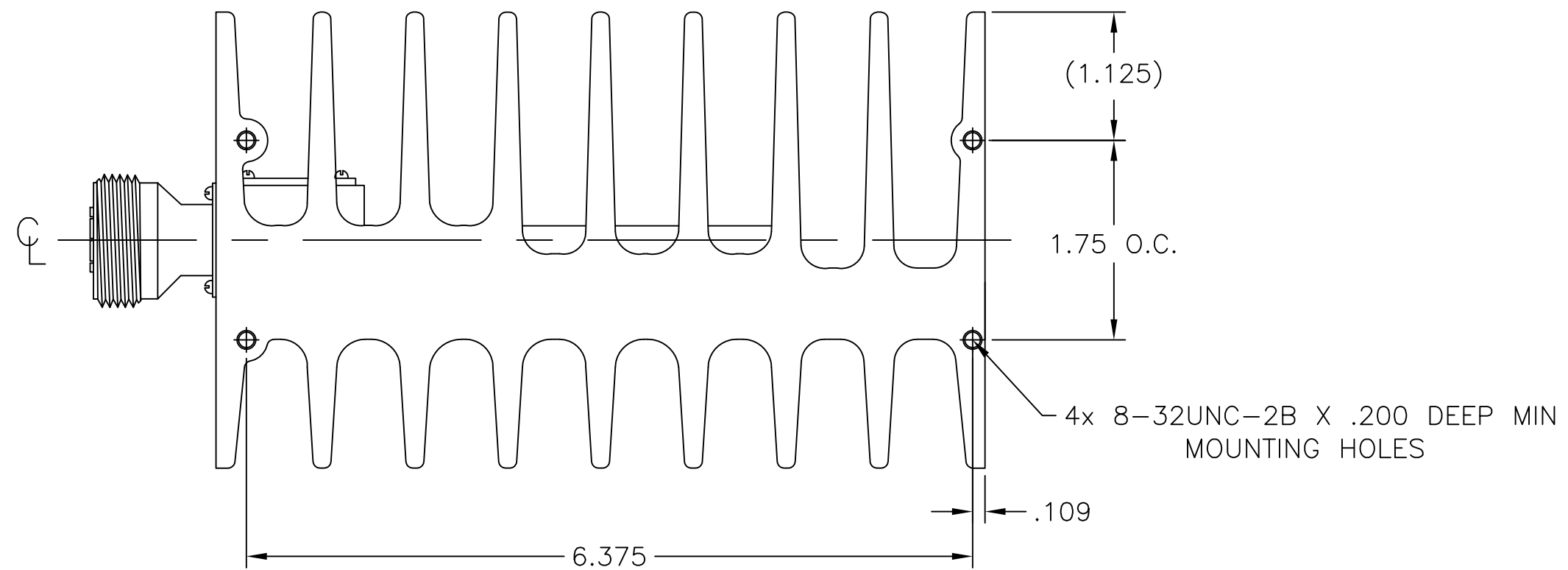

UNLESS OTHERWISE SPECIFIED DIMENSIONS ARE IN INCHES TOLERANCES ARE: FRACTIONS ±1/64 DECIMALS .XX = ±.010 .XXX = ±.005 ANGLES ±30' MILLIMETERS .X = ±.4 .XX = ±.12 DO NOT SCALE DRAWING		APPROVALS DRN DMD CHK APP	DATE 2-17-11		
THIS DRAWING IS THE PROPERTY OF THE BIRD TECHNOLOGIES GROUP OR BIRD ELECTRONIC CORPORATION. THE DESIGNS AND SPECIFICATIONS DISCLOSED HEREON ARE PROPRIETARY AND SHALL NOT BE REPRODUCED, NOR COPIED, NOR USED AS THE BASIS FOR THE MANUFACTURE OR SALE OF APPARATUS OR DEVICES WITHOUT THEIR EXPRESS WRITTEN CONSENT.		MATERIAL CODE	TITLE TERMINATION, CONVECTION COOLED, 7/16 DIN FEMALE, DC-3GHz, 150W		
C		FSCM NO. 70998	SCALE 1:1	DWG. NO. 150-ST-FE	REV B
PROJ./LIB AUTOCAD		COMM CODE LD1	SHEET 1 OF 1		

4

3

2

1